



# DB PROGETTI SRL

## Quick Opening & Actuating Closures

### DB SPEEDLOCK

DB PROGETTI designs and produces Quick Opening / Actuating Closures (QOC / QAC), following international regulations, for equipment with vertical or horizontal configuration, that require opening and closing operations in reduced time, such as:

- Pig traps
- Filters
- Scrubbers
- Manways openings

Our technicians are available to help you select the best solution for your specific needs.

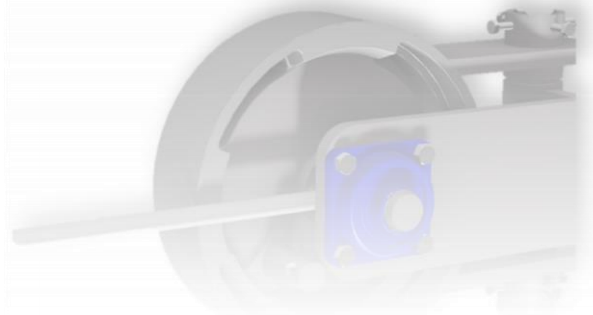
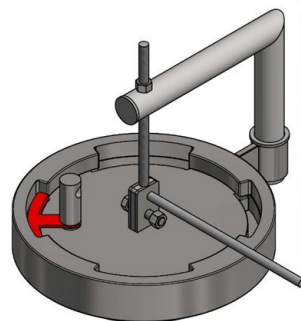
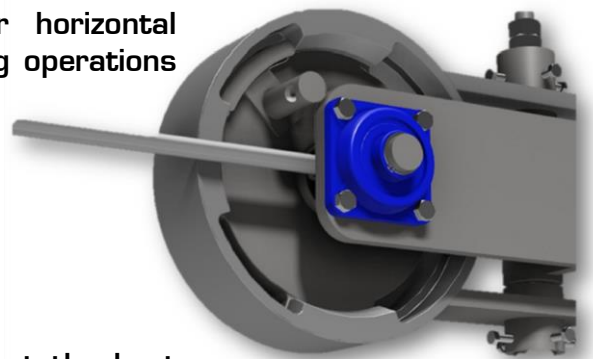

DB SPEEDLOCK consists of a body and a cover with a system of interlocking teeth made of forged material, which prevents the opening of the QOC.

The design and 3D simulation of the hinge, allow the quick unlocking and opening of the closure due to a simple rotation.

This rotation is generally manually operated by means of a gear wheel and a pinion, or by means of the reducer with a handwheel in case of particularly heavy closures.

The seal is guaranteed by a special custom-made lip seal, in order to adapt to different fluids and design temperatures. Operator safety is guaranteed by the standard security lock.

# DB SPEEDLOCK

DB SPEEDLOCK is available in both horizontal (with hinge support) and vertical (with davit support) versions and hydraulic system on request.

The available pressure range goes from ASME 150# to 2500# and API 10000, and the dimension goes from 4" up to 64", the temperature goes from -50° to 650°.

The QOC can be made in carbon steel, stainless steel and alloy materials.



## TECHNICAL DATA

<b>DIMENSIONS</b>	<b>FROM 4" UP TO 64"</b> (other sizes available upon request)
<b>RATING</b>	<b>FROM 150# UP TO 2500# / API 10000</b>
<b>CONSTRUCTION MATERIAL</b>	<b>CARBON STEEL / STAINLESS STEEL / ALLOY</b>
<b>HINGE ORIENTATION</b>	<b>RIGHT OR LEFT</b>
<b>FINAL COATING</b>	<b>ANTI-RUST</b>
<b>SEAL TYPE</b>	<b>LIP SEAL (PUR / HNBR / VITON)</b>
<b>SECURITY SYSTEM</b>	<b>SAFETY VALVE AS PER ASME VIII DIV.1 UG-35 AND ASME VIII DIVISION 2 PARA. 4.8</b>

## OPTIONALS ON REQUEST

**FINAL COATING ACCORDING TO CUSTOMERS' SPECIFICATIONS**

**PARTIAL ASME STAMP INSPECTION**

**KEY INTERLOCK SYSTEM**

**HYDRAULIC TEST**

**WELD OVERLAY**

**HYDRAULIC LIFTING OPENING AVAILABLE FOR VERTICAL TYPE**